



MODEL DT DIRECT VENT INSTALLATION INSTRUCTION SUPPLEMENT

Direct Vent DT Chimney Liner System for use with Gas Appliances

APPLICATION

These instructions apply to the Selkirk MetalBest Direct Vent DT Chimney Liner System. This venting system, in combination with the gas appliance, has been tested and listed as a decorative gas appliance system, or as a direct vent heater system by a major testing agency such as UL, AGA, CGA, Omni or Warnock Hersey. Check the manufacturer's rating plate and instruction manual to confirm that the Selkirk MetalBest Direct Vent DT Chimney Liner System is approved for use on the brand name appliance you have selected.

IMPORTANT

Read all instructions carefully before starting the installation. Failure to follow these instructions may create a fire or other safety hazard, and will void the warranty. Be sure to check the appliance manufacturer's installation instructions for specific venting and clearance to combustible requirements, which may vary from one appliance to another. **Do not extend the venting system in excess of the distance prescribed in the appliance manufacturer's installation instructions.**

INSTALLATION PRECAUTIONS

The Selkirk MetalBest DT Direct Vent Chimney Liner System is an engineered product that has been designed and tested for use with an approved list of direct vent gas appliances. The Selkirk warranty will be voided, and serious fire, health, or other safety hazards may result from any of the following actions:

- Installation of any damaged Chimney Liner component.
- Unauthorized modification of the Chimney Liner System
- Installation of any component part not manufactured or approved by Selkirk MetalBest
- Installation other than as instructed by Selkirk MetalBest and the appliance manufacturer.

Consult your local building codes before beginning the installation.



WARNING

Failure to follow the installation instructions could cause **FIRE, CARBON MONOXIDE POISONING, OR DEATH.**
If you are unsure of installation requirements, call the Phone Number listed on the instructions, 1.800.433.6341 or visit www.selkirkcorp.com.

- **Always maintain required clearances (air spaces) to nearby combustibles to prevent a fire hazard.** Be sure to check the appliance manufacturer's installation instructions for minimum clearance requirements between the outer walls of the vent pipe/liner system and nearby combustible surfaces. Be sure to check the vent termination clearance requirements from decks, windows, soffits, gas regulators, and air supply inlets, as specified in local building codes.
- **The gas appliance and vent system must be vented directly to the outside of the building, and never be attached to a chimney serving a separate solid fuel or gas-burning appliance.** Each direct vent gas appliance must use its own separate vent system. Common vent systems are prohibited.

SAFETY PRECAUTIONS FOR THE INSTALLER

- Wear gloves and safety glasses for protection.
- Exercise extreme caution when using ladders or on rooftops.
- Be aware of electrical wiring locations in walls and ceilings.

PLANNING YOUR INSTALLATION

Note: The flexible liner is 3" in diameter. For installation in a zero clearance chimney, you must have at least a 7" I.D. to properly run the two lines of Flex Liner needed.

The Direct Vent DT Chimney Liner System was designed to be installed in an existing masonry or zero clearance chimney, and connected to either a stove, insert or other appropriate direct vent gas appliance. **(Figure 1)** It is important to carefully measure the length of flex needed to reach from the appliance outlet to the termination cap. If the flex length is too short, a flex coupler will be needed to attach an additional length of Flex Liner to make up the difference. If the flex length is too long, the liner could sag below the appliance outlet which could result in a potential fire hazard.

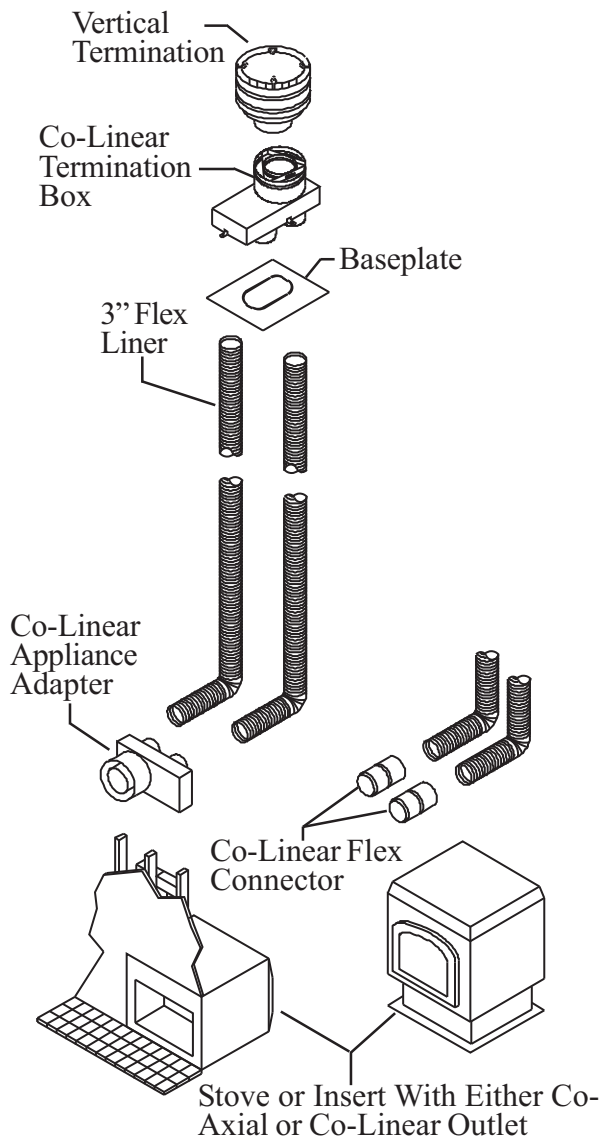

Figure 1

Step 1. Measure and record dimensions to determine total Flex Liner length requirements (see instructions below for details).

Step 2. Insert a rope through the end of the Flex Puller and tie a knot at the end of the rope. Attach the Flex Puller to the Flex Liner using four sheet metal screws as shown. **(Figure 2)** Carefully feed the liner down the chimney (masonry or zero clearance) and out through the damper. One person should feed the liner through the chimney, and another person should pull the liner from the bottom, using the rope to guide the liner through to the chimney bottom. **Note:** If additional lengths of Flex Liner are needed span the chimney height, use a Flex Coupler to connect the pieces of Flex Liner together. Connect the flex to the coupler by using four sheet metal screws for each side. **(Figure 3)**

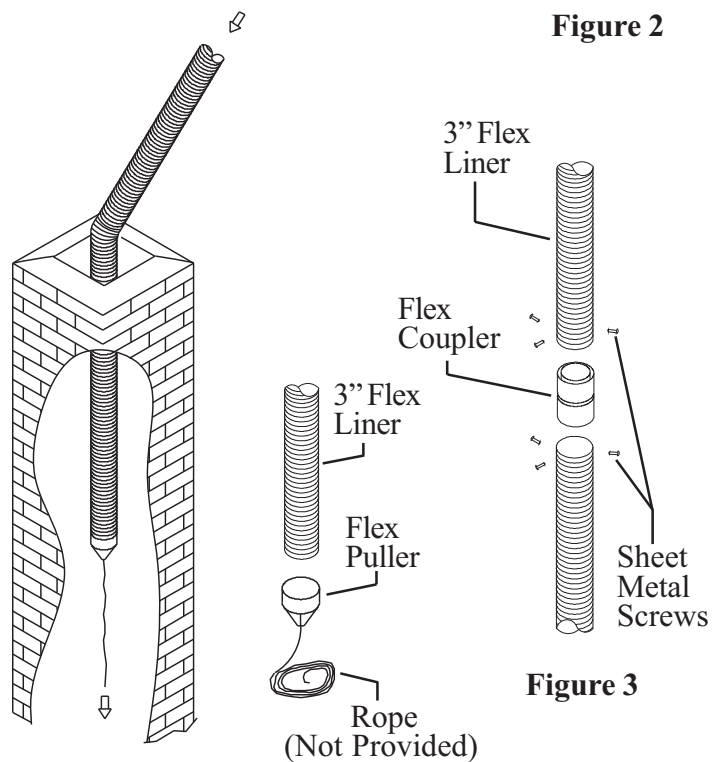

Figure 2

Figure 3

Step 3. After carefully feeding the Flex Liner down the chimney to the bottom, form an angle to line up the Flex Liner with the vent opening on the appliance. Important: Do not let the Flex Liner sag below the level at which it will connect to the appliance or connector. This could allow hot gas to become trapped and potentially become a fire hazard. The Flex Liner path should always be sloped up toward the Termination Cap.

Step 4. Remove the Flex Puller from the Flex Liner and temporarily secure the Flex Liner at the top of the chimney. Be sure to leave 2-3 inches of flex above the existing chimney to allow for connection to the Termination Box **(Figure 4)**

Step 5. Repeat Steps 1-4 for the second length of Flex Liner.

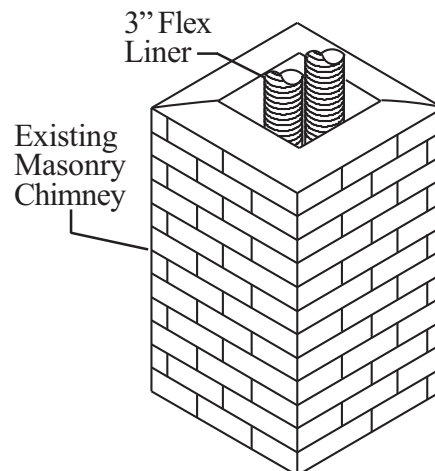

Figure 4

Step 6. At the top of the chimney, slide the Baseplate over the two ends of the Flex Liner and secure it to the surrounding masonry using masonry anchor bolts. Before installing the baseplate, run a bead of non-hardening sealant between the Baseplate and the masonry to prevent moisture from entering the chimney. **(Figure 5)**

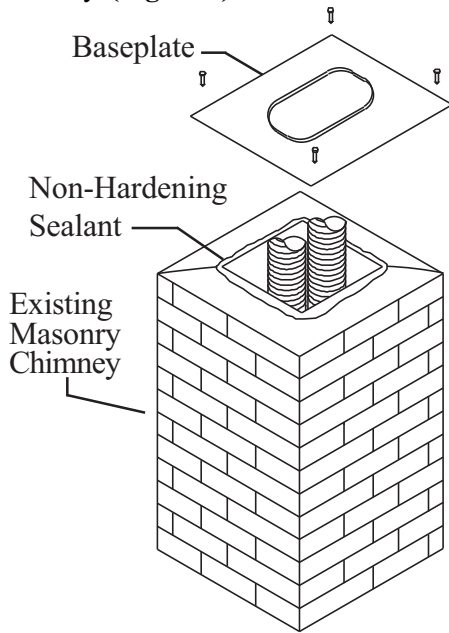

Figure 5

Note: Verify that there is sufficient room to mount the Baseplate on to the masonry. You must have a level surface in order to install the Baseplate properly.

Step 7. Attach the Flex Liner ends at the top of the chimney to the Co-Linear Termination Box. Use four sheet metal screws to connect each Flex Liner run to the Termination Box. **(Figure 6)** Mount the Termination Box to the Baseplate using sheet metal screws as shown. **(Figure 7)**

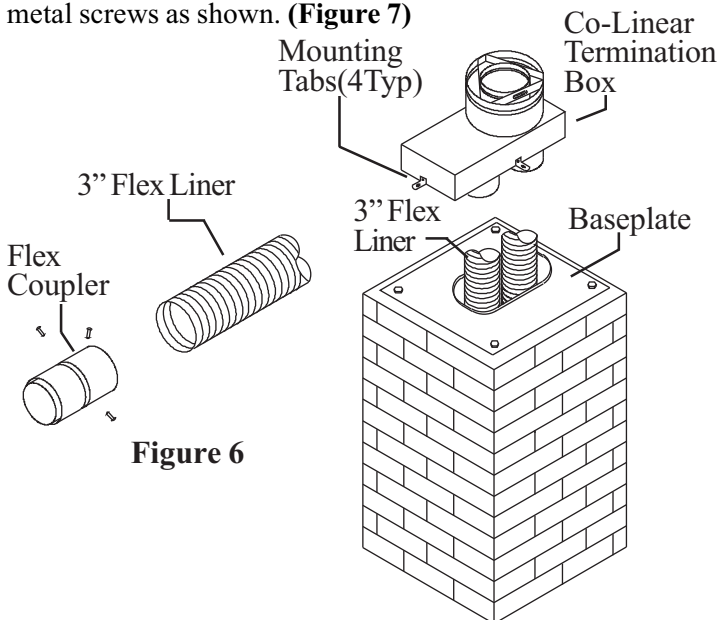

Figure 6

Figure 7

Step 8. Install the Vertical Termination to the Termination Box. **(Figure 8)**

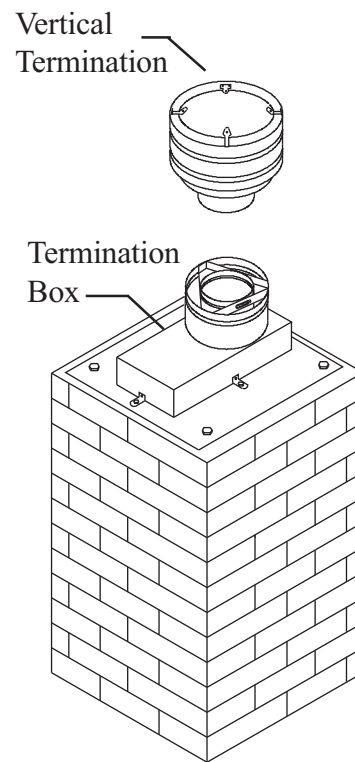

Figure 8

Step 9. Depending upon the type of connection that your appliance has, it will require either the Co-Linear Flex Connectors or a Co-Linear Appliance Adapter in order to attach the Flex Liners to the appliance. For the Co-Linear connection, attach the Co-Linear Flex Connectors to the two outlets on the back of the appliance. See the appliance manufacturer's instructions for details. Connect the two Flex Liner runs to the Connectors using four sheet metal screws each. For the Co-Axial connection, install the Co-Linear Appliance Connector to the adaptor on the appliance. Attach the Flex Liners to the Appliance Connector using four sheet metal screws each. **(Figure 9)** In either case, make sure the Flex Liners do not sag behind the appliance. Finally, move the appliance into its appropriate place.

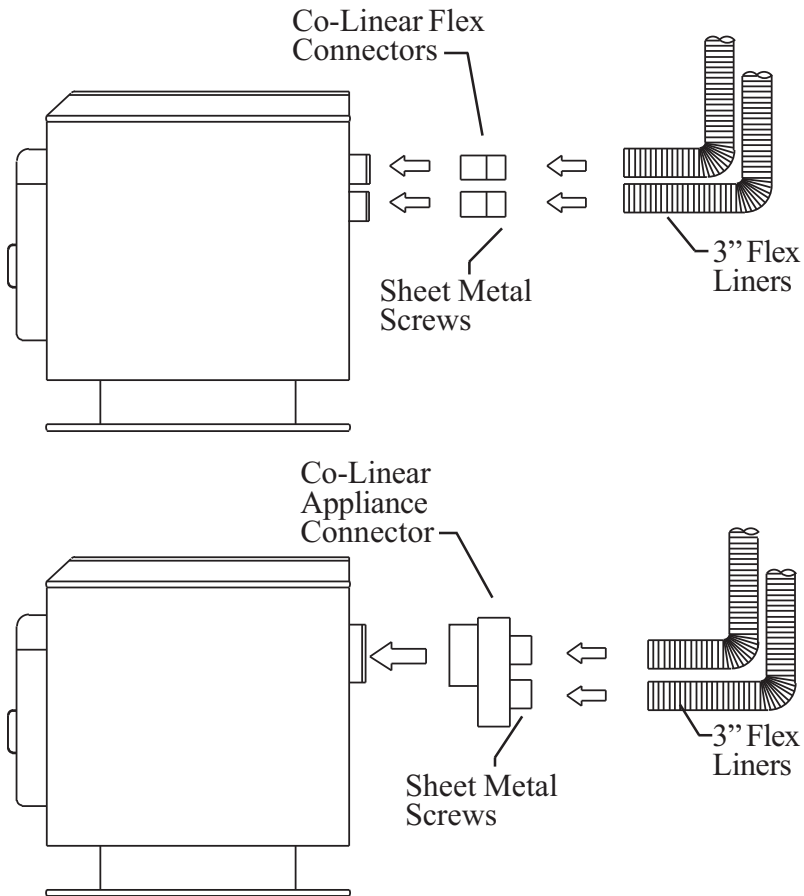

Figure 9

GENERAL MAINTENANCE

Conduct an inspection of the venting system semiannually. Recommended areas to inspect are as follows:

1. Check areas of the Venting System which are exposed to the elements for corrosion. These will appear as rust spots or streaks, and in extreme cases, holes. These components should immediately be replaced.
2. Remove the cap and remove any bird nests, or other foreign material.
3. Check for evidences of excessive condensate, such as water droplets forming in the liners, and subsequently dripping out at joints. Continuous condensate can cause corrosion of caps, liners, and fittings. It may be caused by having exterior portions of the system being exposed to cold weather.