

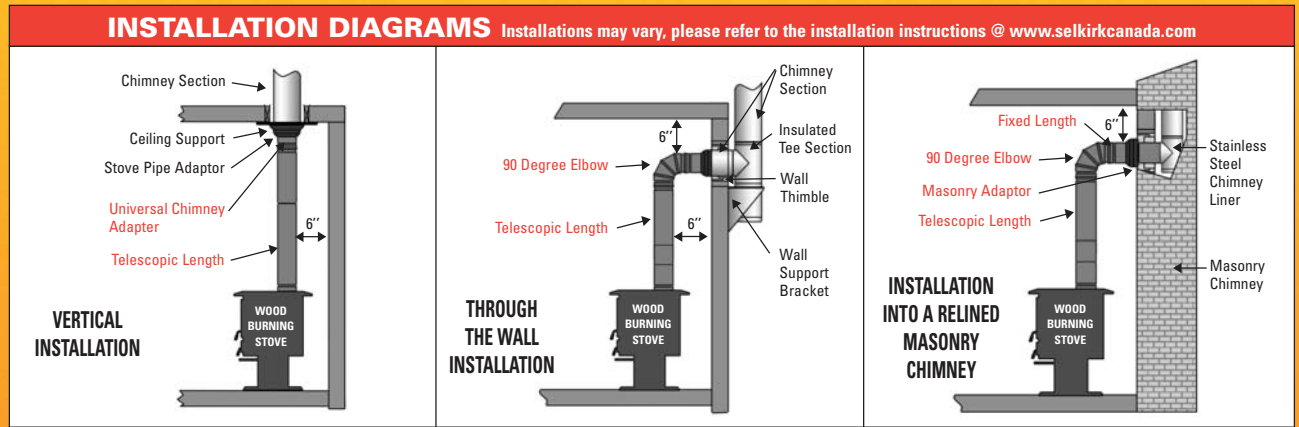

the Vital Link between your Wood Stove & Insulated Stainless Steel Chimney.

ADVANTAGES OF MODEL DSP DOUBLE WALL STOVE PIPE:

- Lasts significantly longer than single wall stove pipe
- Only 6" Clearance to combustible materials
- Stainless Steel inner liner
- Aluminized Steel outer casing
- 1/4" air insulation
- Black enamel finish
- Easy to install
- Certified to UL & ULC Standards
- Lifetime Warranty



PART SELECTION DIAGRAMS

Telescopic Length Includes Finishing Band Installs from 38" to 68" Dia. SKU# 6" DSP6TL 7" DSP7TL 8" DSP8TL	90° Elbow Dia. SKU# 6" DSP6E9-1 7" DSP7E9-1 8" DSP8E9-1	Stove Adaptor Dia. SKU# 6" DSP6SA-1 7" DSP7SA-1 8" DSP8SA-1	Flush Stove Adaptor Dia. SKU# 6" DSP6FSA-1 7" DSP7FSA-1 8" DSP8FSA-1																																							
	45° Elbow Dia. SKU# 6" DSP6E4-1 7" DSP7E4-1 8" DSP8E4-1	Damper Kit Dia. SKU# 6" DSP6DK-1 7" DSP7DK-1 8" DSP8DK-1	Increaser Size Dia. SKU# 6" to 7" 6" DSP167 7" to 8" 7" DSP178 6" to 8" 8" DSP168																																							
Fixed Lengths <table border="1"> <tr><th>Lengths</th><th>Dia.</th><th>SKU#</th></tr> <tr><td>6"</td><td>6"</td><td>DSP6P6-1</td></tr> <tr><td>7"</td><td>7"</td><td>DSP7P6-1</td></tr> <tr><td>8"</td><td>8"</td><td>DSP8P6-1</td></tr> <tr><td>12"</td><td>6"</td><td>DSP6P12-1</td></tr> <tr><td>7"</td><td>7"</td><td>DSP7P12-1</td></tr> <tr><td>8"</td><td>8"</td><td>DSP8P12-1</td></tr> <tr><td>24"</td><td>6"</td><td>DSP6P24-1</td></tr> <tr><td>7"</td><td>7"</td><td>DSP7P24-1</td></tr> <tr><td>8"</td><td>8"</td><td>DSP8P24-1</td></tr> <tr><td>36"</td><td>6"</td><td>DSP6P36-1</td></tr> <tr><td>7"</td><td>7"</td><td>DSP7P36-1</td></tr> <tr><td>8"</td><td>8"</td><td>DSP8P36-1</td></tr> </table>	Lengths	Dia.	SKU#	6"	6"	DSP6P6-1	7"	7"	DSP7P6-1	8"	8"	DSP8P6-1	12"	6"	DSP6P12-1	7"	7"	DSP7P12-1	8"	8"	DSP8P12-1	24"	6"	DSP6P24-1	7"	7"	DSP7P24-1	8"	8"	DSP8P24-1	36"	6"	DSP6P36-1	7"	7"	DSP7P36-1	8"	8"	DSP8P36-1	Tee with Plug Dia. SKU# 6" DSP6TE-1 7" DSP7TE-1 8" DSP8TE-1	Insulated Wall Thimble Dia. SKU# 6" DSP6IWT 7" DSP7IWT 8" DSP8IWT	Reducer Size Dia. SKU# 7" to 6" 6" DSPR76 8" to 7" 7" DSPR87 8" to 6" 8" DSPR86
	Lengths	Dia.	SKU#																																							
6"	6"	DSP6P6-1																																								
7"	7"	DSP7P6-1																																								
8"	8"	DSP8P6-1																																								
12"	6"	DSP6P12-1																																								
7"	7"	DSP7P12-1																																								
8"	8"	DSP8P12-1																																								
24"	6"	DSP6P24-1																																								
7"	7"	DSP7P24-1																																								
8"	8"	DSP8P24-1																																								
36"	6"	DSP6P36-1																																								
7"	7"	DSP7P36-1																																								
8"	8"	DSP8P36-1																																								
Adjustable Length Includes Finishing Band Installs from 12" to 18" Dia. SKU# 6" DSP6AL-1 7" DSP7AL-1 8" DSP8AL-1	Universal Chimney Adaptor Dia. SKU# 6" DSP6CA 7" DSP7CA 8" DSP8CA		Masonry Adaptor Dia. SKU# 6" DSP6MA 7" DSP7MA 8" DSP8MA																																							
		Oval to Round Adaptor Dia. SKU# 8" DSP8OTR Only available in 8" Diameter	Universal Finishing Band SKU# DSP-FB																																							

		Single Wall Stove Pipe
Tested and labelled	ULC S641 / UL 103	Not tested or labelled
Material	Heavy gauge stainless steel / aluminized steel	Light gauge carbon steel
Clearance to combustibles	6 inches	18 inches
Warranty	Lifetime Warranty	No Warranty



SELKIRK CANADA CORPORATION

375 Green Road, Stoney Creek, ON, Canada L8E 4A5
 P: 1-888-SELKIRK (735-5475)
 F: 1-866-835-9624
 E: info@selkirkcanada.com
 W: www.selkirkcanada.com