



## Fire Chief Wood/Coal Furnaces

Indoor FC450 FC500E FC700E FC1100E

Outdoor FCOS1800D FCOS2200D



# WHY BUY A FIRE CHIEF FURNACE?

Fire Chief Furnaces are built to the highest standards of manufacturing excellence. We have listened to the constructive critique of our loyal customers for 30 years. Who knows better than the consumer? Our units are built to stand the test of time using the best materials in the industry. Our Saint Louis-based company produces the #1 wood/coal forced-air furnace in America. Don't take our word, ask a satisfied owner of a Fire Chief.



---

### **Easy to Use & Maintain**

Fire Chief furnaces are designed with ease-of-use in mind. Over the years we've perfected our furnaces so you can heat your home without worry or complications. The pre-wired electrical system is easy to attach - saving time and money. Many of our units come standard with automatic draft control, digital wall thermostat and take a 20 x 25 x 1 filter. More than 95% of our furnaces are installed by the homeowner.

---

### **Maximum Efficiency & Maximum Heat**

Fire Chief furnaces have the strongest blower in the industry (1/3-horsepower compared with the industry standard 1/8-horsepower and 1/10-horsepower units). Fire Chief delivers faster and stronger air flow. Our unique secondary combustion chamber ensures higher efficiency, re-burning wood gases and smoke. Our multi-directional cast iron baffle directs combustion air above and below the grates to create maximum efficiency. In addition, burning wood (a natural resource) reduces greenhouse gas emissions caused by burning costly fossil fuels such as oil, propane, and gas.

---

### **Highest Quality Standards**

Fire Chief has the best warranty in the industry. Our unique 360° rotating cast iron roller grate system, on premium indoor models, allows for separation of fine ash and carries a limited lifetime warranty. Our blower motors have a 2 year warranty and our air tight fireboxes, continuously welded inside and outside, have a 5 year warranty. Fire Chief is made entirely in the USA. All furnaces are tested to UL391 standard by Intertek. For our outdoor units, the patented heat release mechanism protects Fire Chief's electrical system during power outages.

---

### **Reliable Support Network**

We partner with our dealer network which provides training and support throughout the season. Fire Chief does not outsource Customer Technical Support services. Our toll free number is answered by a trained support team member in St. Louis, Missouri.

## FC450 INDOOR

WOOD & COAL BURNING - TESTED TO UL391

HEATING AREA = 1500-2000 SQ FT

MAXIMUM BTUs = 100,000

LOG SIZE = 22"

FIREBOX = 7.1 CUBIC FT

BLOWER CAPACITY = 1500 CFM

FIREBOX = 5 YEAR WARRANTY

STANDARD FILTER BOX = 20"x25"x1"

BI-METAL THERMOSTAT DRAFT CONTROL

PRE-WIRED FOR EASY ASSEMBLY

SHIPPING WEIGHT = 505 LBS



## FC500E / FC700E / FC1100E INDOOR

WOOD & COAL BURNING - TESTED TO UL391

HEATING AREA = 1500-2000 SQ FT (FC500E)

2500-3500 SQ FT (FC700E)

3500-5000 SQ FT (FC1100E)

LOG SIZE = 22" (FC500E) 28" (FC700E) 34" (FC1100E)

FIREBOX = 7.1 CUBIC FT (FC500E)

8.9 CUBIC FT (FC700E)

11.3 CUBIC FT (FC1100E)

BLOWER CAPACITY = 1200, 1500, 1800 CFM

CAST IRON ROLLER GRATES = LIFETIME WARRANTY

SECONDARY COMBUSTION CHAMBER

FIREBOX = 5 YEAR WARRANTY

MAXIMUM BTUs = 100,000 (FC500E)

150,000 (FC700E)

200,000 (FC1100E)

STANDARD FILTER BOX = 20"x25"x1"

SHIPPING WEIGHT = 555 LBS (FC500E)

615 LBS (FC700E)

705 LBS (FC1100E)

DIGITAL WALL THERMOSTAT DRAFT CONTROL

PRE-WIRED FOR EASY ASSEMBLY



## FCOS1800D OUTDOOR

WOOD BURNING - TESTED TO UL391

HEATING AREA = 1500-2500 SQ FT

MAXIMUM BTUs = 140,000

LOG SIZE = 28"

FIREBOX = 8.9 CUBIC FT

BLOWER CAPACITY = 1800 CFM

FIREBOX = LIMITED 5 YEAR WARRANTY

DIGITAL WALL THERMOSTAT DRAFT CONTROL

PRE-WIRED FOR EASY ASSEMBLY

SECONDARY COMBUSTION CHAMBER

SHIPPING WEIGHT = 780 LBS

25 FT FLEX HEAT DUCT



## FCOS2200D OUTDOOR

WOOD BURNING - TESTED TO UL391

HEATING AREA = 2500-3500 SQ FT

MAXIMUM BTUs = 180,000

LOG SIZE = 32"

FIREBOX = 10.8 CUBIC FT

BLOWER CAPACITY = 1800 CFM

FIREBOX = LIMITED 5 YEAR WARRANTY

DIGITAL WALL THERMOSTAT DRAFT CONTROL

PRE-WIRED FOR EASY ASSEMBLY

SECONDARY COMBUSTION CHAMBER

SHIPPING WEIGHT = 865 LBS

25 FT FLEX HEAT DUCT



## MODEL

## FC450

BTUs (maximum) HEATING (sq. ft.) LOG SIZE	100,000 APPROX. 1500-2000 22"
FIRE BOX VOLUME BLOWER CAPACITY DOOR SIZE	7.1 CU. FT. 1500 CFM 13"x14"
FLUE SIZE PLENUM SIZE HEIGHT TO CENTER OF FLUE COLLAR	6" 10" ROUND 44.5"
FILTER SIZE HEIGHT WIDTH	20"x25"x1" 50.5" 26"
DEPTH (with filter box) SHIPPING WEIGHT WARRANTY - FIREBOX WARRANTY - GRATES & CASTING	26" 505 LBS. 5 YEAR LIMITED 5 YEAR LIMITED



## FURNACE FEATURES

- Wood Grate System
- Prewired Electrical System
- 1/3 Horsepower 1500 CFM Blower Motor
- Filter Box Standard
- Heavy Gauge Steel, Continuously Welded Fire Box
- Manually Controlled Draft System
- Adjustable Bi-Metal Thermostat, which Provides Automatic Control for Combustion

## ACCESSORIES



10" BACK DRAFT DAMPER

**AM-BD10**



10" GALVANIZED ELBOW

**SNG90-10**

10"x 24" GALVANIZED PIPE

**SNGP24x10**



## MODEL

## FC500E

## FC700E

## FC1100E

BTUs (maximum) HEATING (sq. ft.) LOG SIZE	100,000 APPROX. 1500-2000 22"	150,000 APPROX. 2500-3500 28"	200,000 APPROX. 3500-5000 34"
FIRE BOX VOLUME DIGITAL THERMOSTAT INDUCTION DRAFT BLOWER	7.1 CU. FT. INCLUDED 50 CFM	8.9 CU. FT. INCLUDED 50 CFM	11.3 CU. FT. INCLUDED 50 CFM
3-SPEED BLOWER CAPACITY DOOR SIZE FLUE SIZE	1200, 1500, 1800 CFM 13"x14" 6"	1200, 1500, 1800 CFM 13"x14" 6"	1200, 1500, 1800 CFM 13"x14" 8"
PLENUM SIZE HEIGHT TO CENTER OF FLUE COLLAR FILTER SIZE	12" ROUND 44.5" 20"x25"x1"	12" ROUND 44.5" 20"x25"x1"	12" ROUND 44.5" 20"x25"x1"
HEIGHT WIDTH DEPTH (with filter box)	50.5" 26" 26"	50.5" 26" 31"	50.5" 26" 39"
SHIPPING WEIGHT WARRANTY - FIREBOX WARRANTY - GRATES & CASTING	555 LBS. 5 YEAR LIFETIME	615 LBS. 5 YEAR LIFETIME	705 LBS. 5 YEAR LIFETIME

## ACCESSORIES

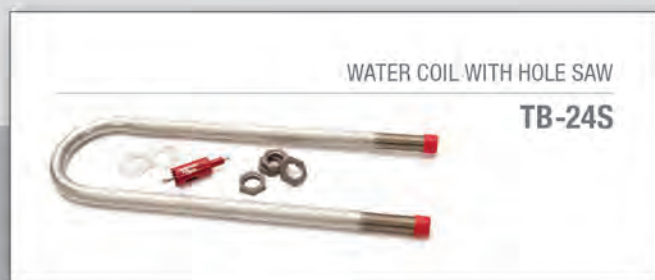

12"x 24" GALVANIZED PIPE **SNG24X12**

## TYPICAL INDOOR FURNACE INSTALLATION

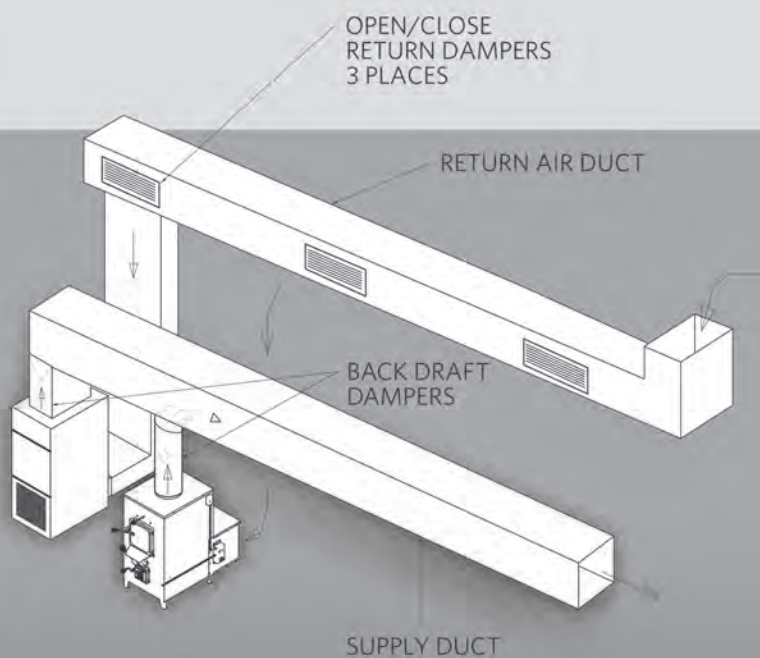

- Best Warranty in the Industry
- 360° Cast Iron Roller Grate
- Prewired Electrical System
- 1/3 Horsepower 3-Speed Blower Motor
- Filter Box Standard
- 7 & 10 Gauge Steel Fire Box
- Secondary Combustion Chamber
- Thermostatically Controlled Draft System



## FURNACE FEATURES

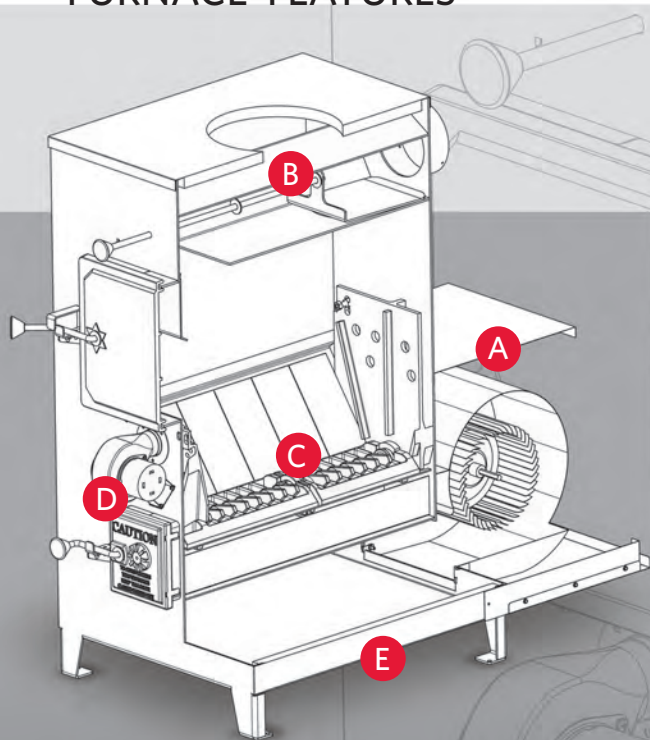

- A** Standard Filter Box (Blower Motor)
- B** Secondary Combustion Chamber
- C** 360° Cast Iron Roller Grate
- D** Induction Draft Blower
- E** Insulated Sides

## MODEL

## FCOS1800D

## FCOS2200D

BTUs (maximum)  
HEATING (sq. ft.)  
LOG SIZE

140,000 APPROX.  
1500-2500  
28"

180,000 APPROX.  
2500-3500  
32"

FIRE BOX VOLUME  
DIGITAL THERMOSTAT  
INDUCTION DRAFT BLOWER

8.9 CU. FT.  
INCLUDED  
50 CFM

9.00 CU. FT.  
INCLUDED  
50 CFM

BLOWER CAPACITY  
DOOR SIZE  
FLUE SIZE

1800 CFM  
13"x14"  
6"

1800 CFM  
13"x14"  
6"

HOT AIR SUPPLY  
HEIGHT  
WIDTH

10" ROUND  
59"  
30"

10" ROUND  
59"  
30"

DEPTH (w/blower housing)  
SHIPPING WEIGHT  
COLD AIR RETURN

59"  
780 LBS.  
12"ROUND

65"  
865 LBS.  
12"ROUND

WARRANTY - FIREBOX  
WARRANTY - GRATES & CASTING  
10" INSULATED HEAT DUCT

5 YEAR LIMITED  
5 YEAR LIMITED  
25 FT.

5 YEAR LIMITED  
5 YEAR LIMITED  
25 FT.

## FURNACE FEATURES

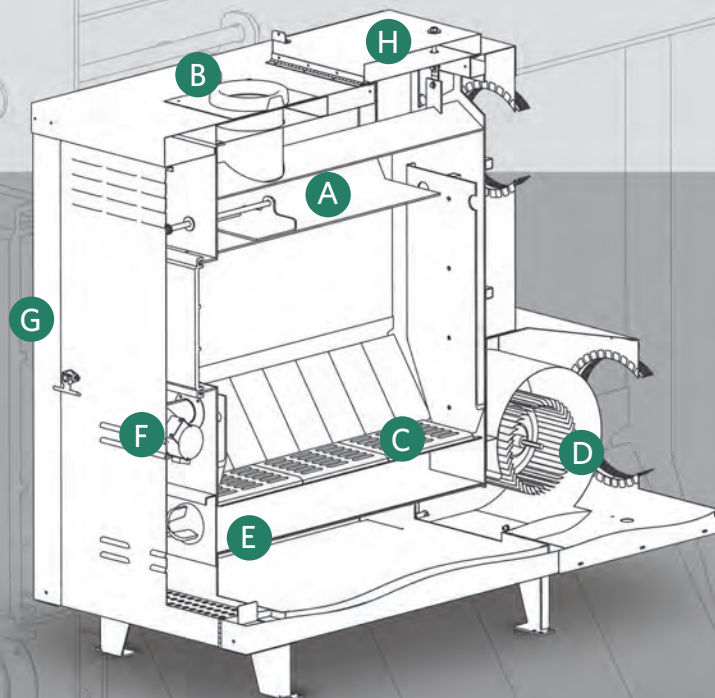

- A** Secondary Combustion Chamber
- B** Anchor Plate for Insulated Chimney
- C** Wood Grates
- D** 1800 CFM Blower Motor
- E** Removable Ash Pan with Spin Draft
- F** Induction Draft Blower
- G** Durable Powder Coat Weather-Resistant Finish
- H** Patented Heat Dump



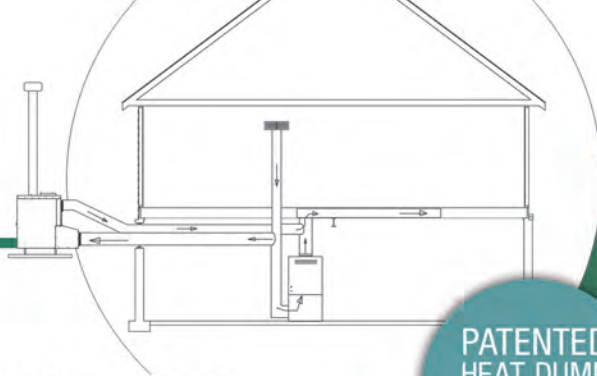

## TYPICAL OUTDOOR FURNACE INSTALLATION

**PATENTED  
HEAT DUMP**  
PROTECTS ADD-ON  
FURNACE IN CASE OF  
POWER LOSS

- Patented Heat Dump
- Prewired Electrical System
- 7 & 10 Gauge Steel Fire Box
- Secondary Combustion Chamber
- Thermostatically Controlled Draft System
- 1/3 Horsepower 1800 CFM Blower Motor



10" x 24" GALVANIZED PIPE

**SNGP24x10**

12" x 24" GALVANIZED PIPE

**SNGP24x12**

## ACCESSORIES



10" BACK DRAFT DAMPER

**AM-BD10**

12" BACK DRAFT DAMPER

**AM-BD12**



10" GALVANIZED ELBOW

**SNG90-10**

12" GALVANIZED ELBOW

**SNG90-12**



10" MANUAL BACK DRAFT DAMPER

**AM-MD10**

12" MANUAL BACK DRAFT DAMPER

**AM-MD12**



8" STARTER COLLAR

**SNGCLR08**

10" STARTER COLLAR

**SNGCLR10**

12" STARTER COLLAR

**SNGCLR12**



RETURN AIR FILTER BOX

**FCOSFB**

- filter size 16"x20"x1"  
- interior use only



MOBILE HOME KIT

**FCMHK**

## OTHER QUALITY PRODUCTS FROM OUR COMPANY

---

### CHIMNEY COVERS

Protect your chimney from cracks and deterioration and keep it free from pests and debris. Single Flue and Multi-Flue available. Heavy Duty construction available in Copper, Stainless Steel and Galvanized Steel. Limited lifetime warranty for Copper and Stainless Steel, 7 year warranty on Galvanized Steel.

Custom-Made Aluminum Chimney Covers also available. Call 1-800-325-7076.



---

### STOVE BOARDS

Protect your floors or walls from intense heat, hot coals and ashes. Use under heating appliances, on the wall behind the appliance, or in front of your fireplace. These UL1618 Type 2 Stoveboards are available in 4 updated patterns.



---

### LOG RACKS & COVERS

Cure your wood to produce maximum BTUs during the heating season. Available in a variety of styles and adjustable sizes, constructed of heavy-duty tubular or 1.25" square 16 gauge steel, with a black powder coat finish that resists chipping and corrosion. Easy to assemble. Log rack covers also available.



## FIREPLACE GRATES

Enhance the look and usefulness of your fireplace with these heavy-duty cast iron and steel bar grates. They are offered in a variety of styles and sizes to suit every taste and fireplace size.



## FLEX LINER KIT

Highly recommended to protect your home from flue fires and creosote build up, the flex liner kit is made from 7-ply 316 stainless steel to provide superior strength and durability. Corrugated construction allows for expansion and contraction during heat up and cool down periods. Limited lifetime warranty.



## CLASS "A" CHIMNEY

ShelterPro Chimney is designed to handle temperatures up to 2100°F with superior durability and safety. The inner liner and outer casing are made from outstanding grade 304 stainless steel, designed to prevent corrosion and keep out moisture. Premium fiber insulation ensures minimal loss of heat. Offered in 6" and 8" diameters and a variety of lengths, includes a lifetime warranty.







*a HY-C Company*

[WWW.FIRECHIEFWOODFURNACE.COM](http://WWW.FIRECHIEFWOODFURNACE.COM)

800-875-4788